

Monthly update – Five Dock

April 2025

Sydney Metro is Australia's biggest public transport project

The NSW Government is delivering Sydney Metro West – a new underground metro railway which will double rail capacity between Parramatta and the Sydney CBD, link new communities to rail services and support employment growth and housing supply.

Acciona Ferrovial Joint Venture (AFJV) has been awarded the contract to deliver 11 kilometres of twin metro rail tunnels between The Bays and Sydney Olympic Park and excavate five new metro stations including a station at Five Dock.

Work during April

The main activities at the Five Dock Station sites throughout April will be site demobilisation at the eastern and western construction sites, utility investigations and ongoing cavern lining works, including delivery and removal of large mobile cranes and a series of concrete pours.

Work planned for April includes:

- Construction of shaft and cavern concrete structures
- Tunnelling support activities including central cavern construction
- Demobilising activities at the eastern construction site including shed disassembly, temporarily closing Second Avenue while lifting equipment out of the site using a mobile crane, every Tuesday and Thursday
- Footpath restoration works on Waterview Street and Second Avenue
- Installing hoarding and banners around the eastern construction site
- Demobilising activities at the western construction site including dismantling, and removing the remaining workforce facilities
- Increased deliveries of equipment to and from the western and eastern construction sites using both sides of Great North Road, Waterview Street and Second Avenue
- Temporarily removing the public parking spaces from the front of the western construction site to assist with site demobilisation works, when required
- Removing the temporary line marking and street signage from Waterview Street, Second Avenue, Great North Road and Garfield Street
- Delivering and removing materials and equipment (out-of-hours deliveries will be notified separately).

Work hours:

Unless otherwise stated, this work will be carried out during standard construction hours:

- **Monday to Friday 7am – 6pm and Saturday 8am – 6pm.**

Some work must be undertaken outside standard construction hours to minimise impacts on traffic and to ensure the safety of motorists, pedestrians, and workers.

Out-of-hours work planned for April includes:

- Dismantling and removing large electrical equipment from the eastern site using a mobile crane on Second Avenue from **6pm to 5am on Tuesday 1 April 2025. Wednesday 2 April 2025** is the contingency date.
- Removing the eastern site gantry crane using a mobile crane on Second Avenue from **8pm to 5am on Monday 7 April 2025. Tuesday 8 April** is the contingency date.

- Removing the remaining workforce facilities from the western site from **6pm to 5am on Tuesday 29 April and Wednesday 30 April 2025. Friday 2 May 2025** is the contingency night and will be notified separately, if needed.
- Removing the temporary line marking and signage from Waterview Street, Second Avenue, Great North Road and Garfield Street from **6pm to 5am on Tuesday 29 April, Wednesday 30 April and Friday 2 May 2025**. The following Tuesday, Wednesday and Friday will be the contingency dates and notified separately, if required.
- Utility and CCTV investigations at both the eastern and western construction sites.
- The remaining cavern lining concrete pour hours have been extended and will now operate from **6am to 10pm**, if needed for every pour. There will be increased vehicles entering site during each pour.

Activities associated with tunnelling support, such as concrete pours, defect repairs and removal of temporary infrastructure and installation of underline service crossings inside the tunnels are **approved for 24-hour operation**.

Equipment used

Equipment used for this work includes but is not limited to: trucks, light vehicles, concrete trucks, concrete pumps, bobcat, jackhammers, elevated work platforms, excavators, street sweepers, vacuum trucks, asphaltting machines, mobile cranes, lighting towers, generators and power tools.

Changes to traffic, pedestrian, and cyclist routes

During the work, traffic control will be in place to assist motorists, pedestrians, and cyclists with any changes to traffic conditions. This may include contraflow lanes, stop-slow traffic controls to assist with truck movements, oversized deliveries and temporary lane or footpath closures.

Five Dock work area map

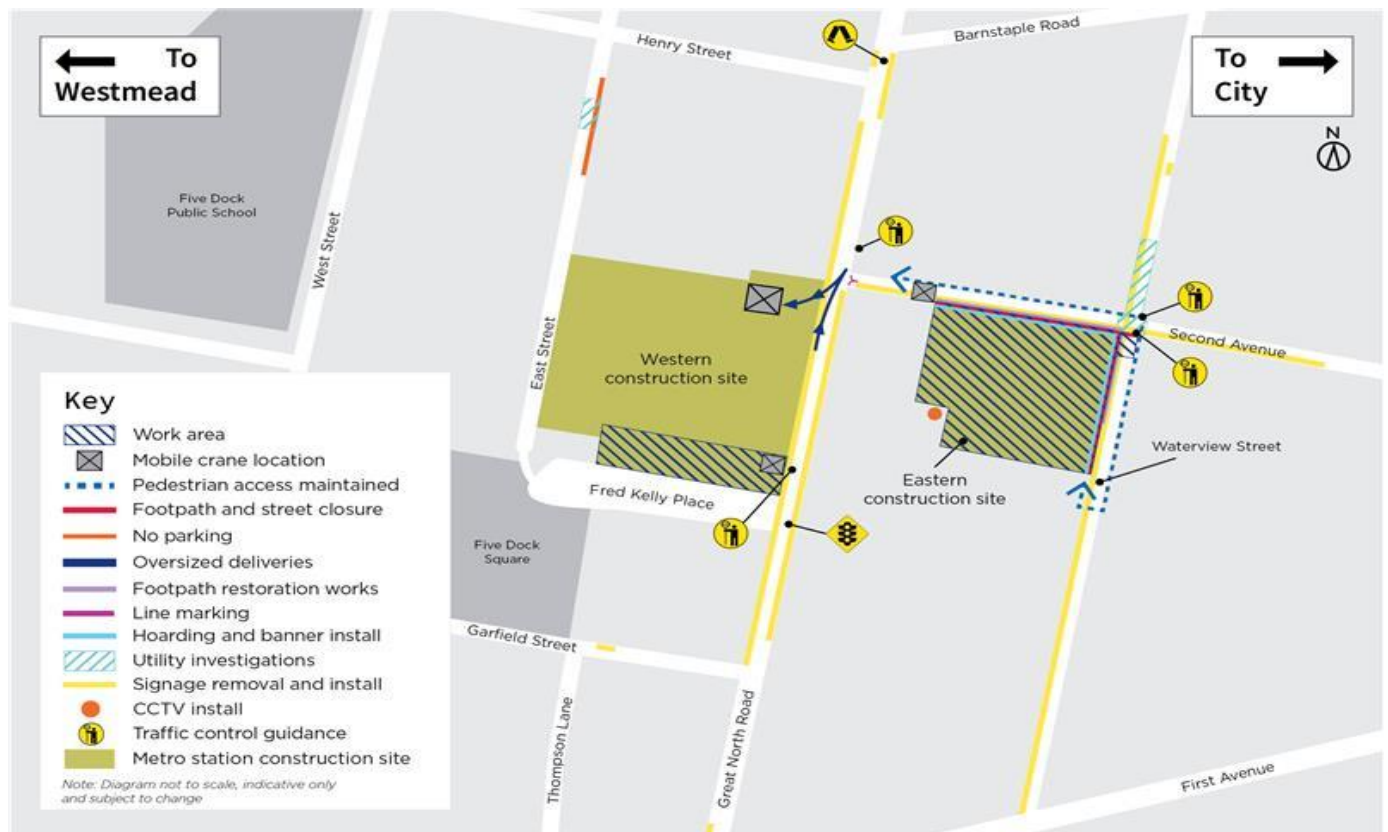

Contact us

Please contact the AFJV community team on **1800 612 173** if you have any questions, complaints or would like to provide feedback about the work.

1800 612 173 Community information line open 24 hours

metrotunnelsAFJV@transport.nsw.gov.au

Sydney Metro West, PO Box K659, Haymarket NSW 1240



Access information in over **100 languages**

Download **Sydney Metro Connect** from the App store or get it on Google Play.



If you need help understanding this information, please contact the Translating and Interpreting Service on **131 450** and ask them to call us on **1800 612 173**