

Upcoming temporary bridge closure – Albermarle overbridge, Marrickville

Weekend and night works - commencing Thursday 27 March 2025

To secure the rail corridor and safe operation of Metro trains, we are replacing the existing rail overbridge railings with screen barriers. Major traffic changes will be implemented while removing and replacing the overbridge railings, including over sized equipment and lifting structures using cranes.

Temporary parking restrictions and detours will be in place during the day and at night from 7am Thursday 27 March until 5am Monday 31 March. From Thursday 27 March, Challis Avenue, Albermarle Street and Kays Avenue East will be local access only. Access will be changed for some residents.

Parking removal is required on Challis Avenue between Kays Avenue West and the turn-around bay at Challis Avenue. Please park in an alternative parking space.

Work will be continuous across the weekend, however we will take breaks from noisier construction work.

Date and time	Activities and Impacts	Location
Thursday 27 March, 7pm until 5am Friday 28 March	Noise from truck movements and unloading equipment. Parking removal and traffic signage establishment.	Challis Avenue (near to Kays Ave West)
Friday 28 March, 7am until 5am Saturday 29 March	Crane delivery and assembly. Utility protections. Noise from removal of existing barriers. Resident access managed by traffic control.	Between 28 and 38 Challis Avenue Challis Avenue, Albermarle Street and beside the rail corridor
Saturday 29 and Sunday 30 March between 7am until 5pm	Crane movements including on Saturday night.	On both sides of the Albermarle Street overbridge
Sunday 30 March from 9pm until 5am Monday 31 March	Removal of equipment and material using trucks. Reinstatement of overbridge and road.	Trucks exiting through Kays Avenue. Overbridge open.



Deliveries may be noisy for short periods and will involve traffic controllers establishing signage and no parking areas, unhooking equipment, lights, and reversing beepers. We will be using crane equipment, hand held powered tools, elevated work platforms, truck mounted crane, tree trimming equipment, construction vehicles, over-sized trucks, delivery trucks, lighting towers and generators.

The team have carefully planned works to minimise impacts on local residents where possible, including reducing the duration of work by delivering equipment at night, staging work to decrease commuter disruption, keeping resident access as much as possible, and ensuring there is parking on Challis Avenue.

During these periods, the Albermarle overbridge will be closed to traffic in both directions, however local access will be managed through traffic control. All other commuters will be detoured around the overbridge. Speed limits will also be reduced to manage the traffic flow during the work period.

If you have any questions please contact the community team via our 24 hour community information line on 1800 171 386 (ask for the CIRA - Corridor Intrusion Risk Assessment team) or e-mail southwestmetro@transport.nsw.gov.a

Work location map – Albermarle Road overbridge

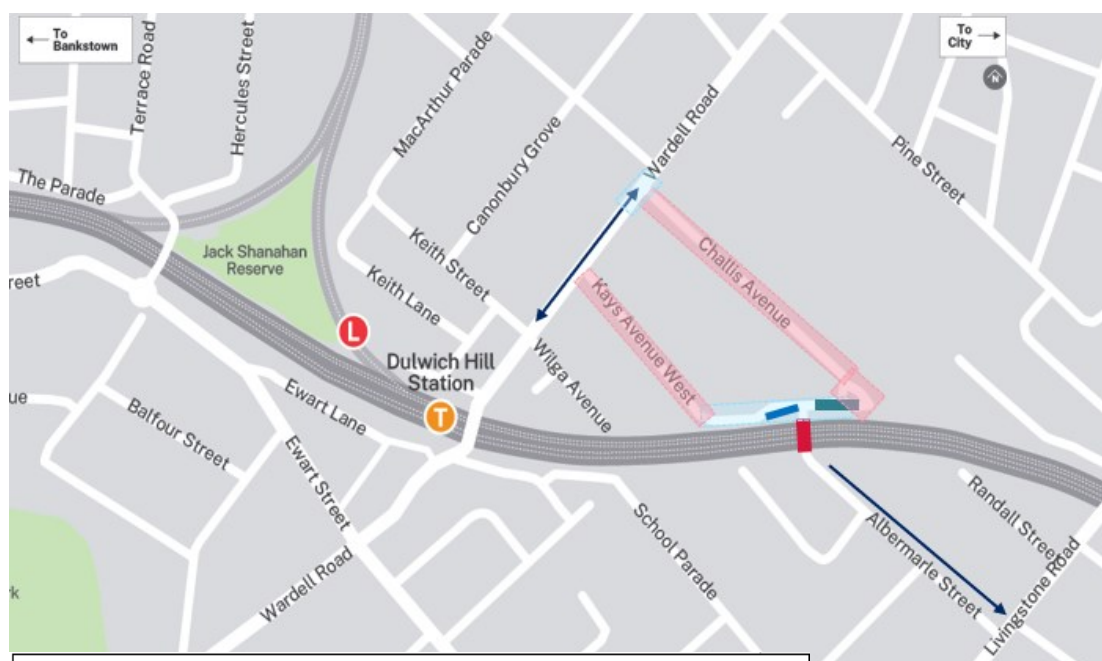

Key

- Dulwich Hill train station
- Work location (no local or commuter access)
- Crane location
- Oversize truck parking location
- Temporary parking removal (Thursday to Monday)
- Temporary local access only, parking removal and truck delivery route
- Detour around the work area (please follow instructions of traffic control)
- Inner West light rail

Note: Diagram not to scale, indicative only and subject to change.

Contact us

- 24-hour Community Information Line **1800 171 386**
- southwestmetro@transport.nsw.gov.au
- Sydney Metro City & Southwest, PO Box K659, Haymarket NSW 1240



Translating and interpreting service

If you need help understanding this information, please contact the Translating and Interpreting Service on **131 450** and ask them to call us on **1800 171 386**