

# Monthly update – Five Dock

December 2024

## Sydney Metro is Australia's biggest public transport project

The NSW Government is delivering Sydney Metro West – a new underground metro railway which will double rail capacity between Parramatta and the Sydney CBD, link new communities to rail services and support employment growth and housing supply.

Acciona Ferroviaria Joint Venture (AFJV) has been awarded the contract to deliver 11 kilometres of twin metro rail tunnels between The Bays and Sydney Olympic Park and excavate five new metro stations including a station at Five Dock.

## Work during December

The main activities at the Five Dock Station sites throughout December will be site demobilisation at the eastern construction site, demobilisation of workforce facilities at the western construction site, and ongoing cavern lining works, including delivery and assembly of the steel formwork and concrete pours.

Work planned for December includes:

- Construction of shaft and cavern concrete structures
- Tunnelling support activities including cross passage and central cavern construction
- Demobilising activities at the eastern construction site including shed disassembly
- Demobilisation activities at the western construction site including removing the walkway roof, removing the existing hoarding, and replacing it with new hoarding, dismantling and moving workforce facilities within the site and installing fencing within Fred Kelly Place
- Increased deliveries of equipment to and from the western construction site using both sides of Great North Road  
Delivering and removing materials and equipment (out-of-hours deliveries and removals will be notified separately).

### Work hours:

Unless otherwise stated, this work will be carried out during standard construction hours:

- **Monday to Friday 7am – 6pm and Saturday 8am – 6pm**

### Work outside standard construction hours:

Some work must be undertaken outside standard construction hours to minimise impacts on traffic and to ensure the safety of motorists, pedestrians, and workers.

### Out-of-hours work planned for December includes:

- A large mobile crane delivery to and from the site to assist with formwork assembly every week **from 2 December 2024 to 20 December 2024**. This will be notified separately.
- Night work to dismantle and remove some workforce facilities within the western construction site. This will also be notified separately.

Activities associated with tunnelling support, such as concrete pours, cross passage construction, defect repairs, removal of temporary infrastructure and installation of underline service crossings inside the tunnels are **approved for 24-hour operation**. This includes tunnelling support activities inside the eastern acoustic shed as well as tunnelling support activities inside the excavated underground cavern and the excavated shaft on the western site

(under strict noise criteria). No work is planned on the surface of the western site after 6pm unless otherwise notified.

### 🎄 Christmas shut down 🎄

While most of the project will shut down over the Christmas and New Year period, from **Friday 20 December 2024 to Monday 6 January 2025**, critical tunnelling related activities will continue to be carried out 24 hours a day, except on 25 and 26 December 2024 and 1 January 2025.

### Equipment used

Equipment used for this work includes but is not limited to: trucks, light vehicles, concrete trucks, concrete pumps, bobcat, jackhammers, elevated work platforms, excavators, street sweepers, vacuum trucks, cranes, light towers, generators and power tools.

### Changes to traffic, pedestrian, and cyclist routes

During the work, traffic control will be in place to assist motorists, pedestrians, and cyclists with any changes to traffic conditions. This may include contraflow lanes, stop-slow traffic controls to assist with truck movements, oversized deliveries and temporary lane or footpath closures.

### Five Dock work area map

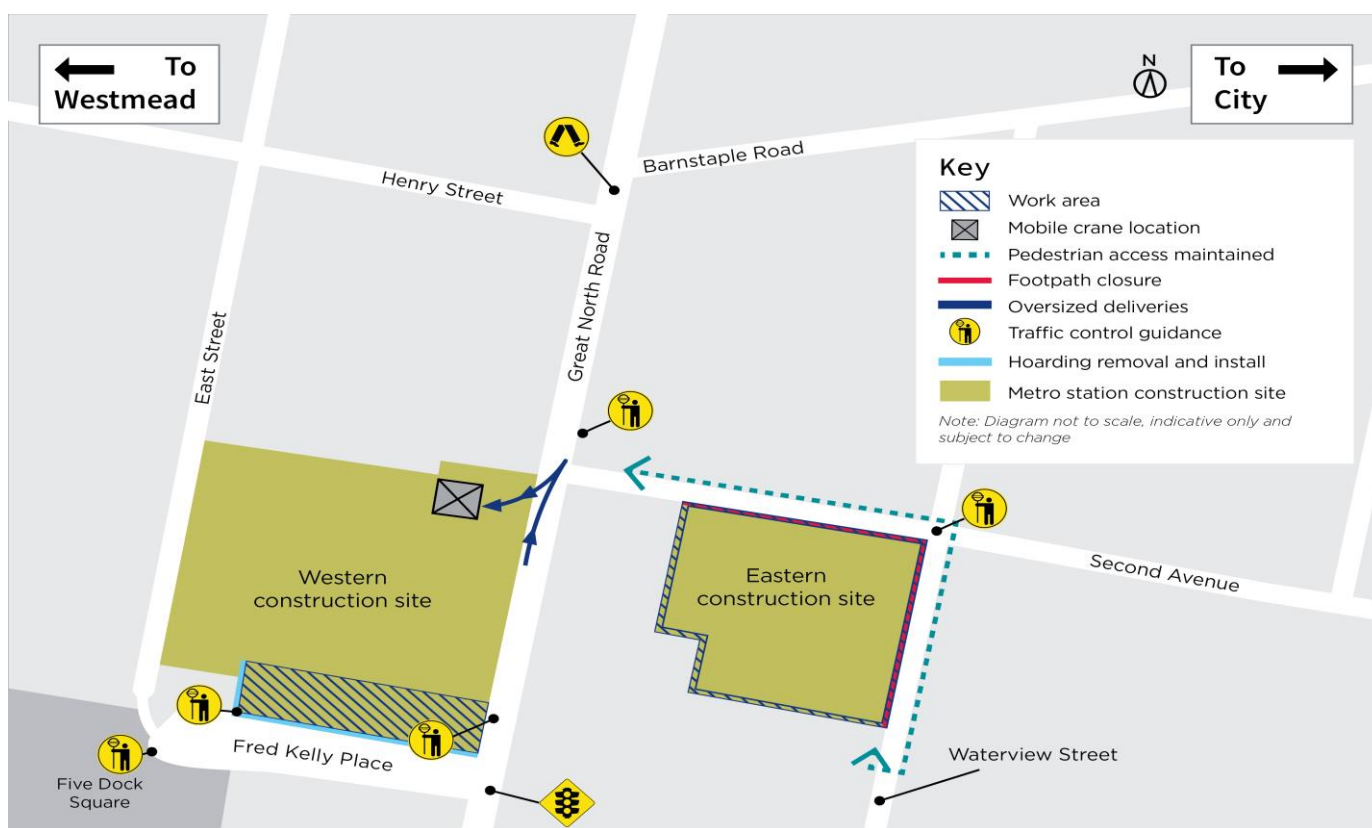

### Contact us

Please contact Amy from the AFJV community team on **1800 612 173** if you have any questions, complaints or would like to provide feedback about the work. AFJV's Community Communications Strategy is available online at [acciona.com.au/sydneymetro-west-ctp](http://acciona.com.au/sydneymetro-west-ctp) (click on plans). If you would like to provide feedback about this plan, please contact the AFJV community team.

**1800 612 173** Community information line open 24 hours

[metrotunnelsAFJV@transport.nsw.gov.au](mailto:metrotunnelsAFJV@transport.nsw.gov.au)

Sydney Metro West, PO Box K659, Haymarket NSW 1240



Access information in over **100 languages**

Download **Sydney Metro Connect** from the App store or get it on Google Play.



If you need help understanding this information, please contact the Translating and Interpreting Service on **131 450** and ask them to call us on **1800 612 173**