

# Notification – Five Dock

5 September 2024

## Sydney Metro is Australia's biggest public transport project

The NSW Government is delivering Sydney Metro West – a new underground metro railway which will double rail capacity between Parramatta and the Sydney CBD, link new communities to rail services and support employment growth and housing supply.

Sydney Metro has been granted planning approval to construct twin underground rail tunnels between Westmead and Hunter Street in the Sydney CBD for Sydney Metro West.

Acciona Ferrovial Joint Venture (AFJV) has been awarded the contract to deliver 11 kilometres of twin metro rail tunnels between The Bays and Sydney Olympic Park and excavate five new metro stations, including a station at Five Dock.

## Out-of-hours work at Five Dock

To assist cavern lining activities (the last major construction activity for the Five Dock site), AFJV needs to assemble large and heavy formwork using a 250-tonne mobile crane. The crane will be delivered to the western construction site outside standard construction hours due to road restrictions and to minimise impacts on traffic and ensure the safety of motorists, pedestrians and local businesses.

The crane will be delivered and removed from the western construction site over two (2) consecutive nights starting from **Thursday 12 September 2024 when the crane will be delivered between 8pm and 5am**. It will then be dismantled and removed from site the following night, **Friday 13 September between 8pm and 5am** (weather and site conditions permitting).

### The work will include:

- Setting up traffic control on Great North Road
- Delivery of a 250-tonne mobile crane to the western construction site
- Lifting oversized equipment from the parking lane on Great North Road into the site
- Partially closing a section of the parking lane on Great North Road, under traffic control guidance

### What to expect:

- There will be noise associated with this work, but we will try to minimise this as much as possible
- Lighting will be directed to the work areas and away from residential properties

### Changes to traffic, pedestrian and cyclist routes:

- Traffic control will be in place to assist motorists, pedestrians and cyclists with temporary changes at the work location
- There will be temporary lane and footpath closures on Great North Road
- Two-way traffic will be maintained at all times

### Equipment used:

Equipment used for this work includes but is not limited to: mobile crane, trucks, light vehicles, portable generator, lighting tower, hand tools and traffic control signage.

### Five Dock out-of-hours work area

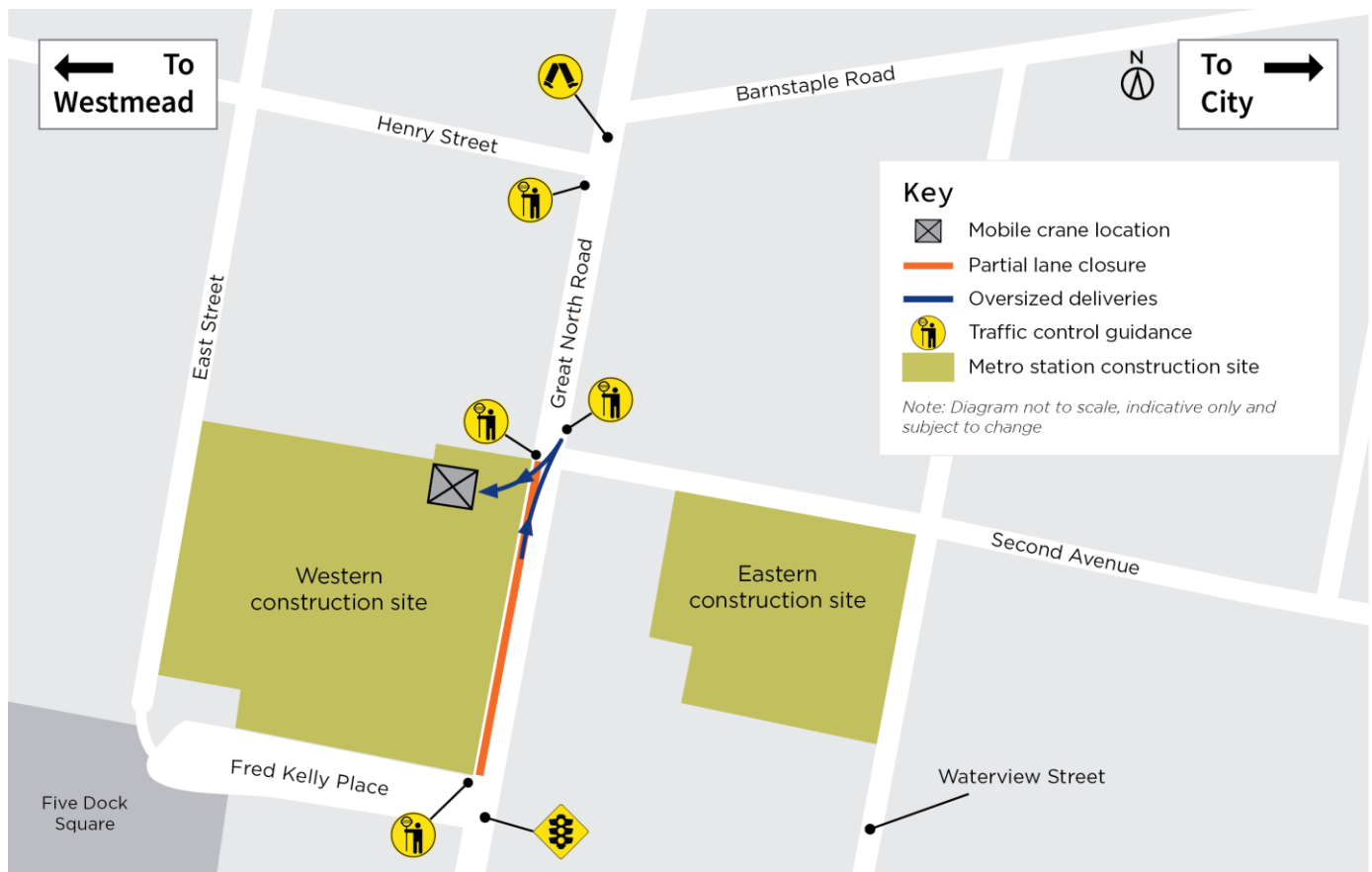

### Contact us:

Please contact Amy from the AFJV community team on **1800 612 173** if you have any questions or would like to provide feedback about the work, including appropriate respite periods. We will continue to keep you updated on the progress of work in your area. If you would prefer to receive updates by email, please send a request to **metrotunnelsAFJV@transport.nsw.gov.au** and we will add you to the distribution list.

Thank you for your cooperation while we complete this essential work.

**1800 612 173** Community information line open 24 hours

**metrotunnelsAFJV@transport.nsw.gov.au**

Sydney Metro West, PO Box K659, Haymarket NSW 1240



Access information in over **100 languages**

Download **Sydney Metro Connect** from the App store or get it on Google Play.



If you need help understanding this information, please contact the Translating and Interpreting Service on **131 450** and ask them to call us on **1800 612 173**