

ARCHITECTURAL DRAWINGS – BUILDING ENVELOPE

APPENDIX D



**VICTORIA CROSS OSD
BUILDING ENVELOPE**

A01.001	Indicative Ground Floor Plan
A01.002	Miller Street Elevation
A01.003	East West Section
A01.004	North West Axonometric
A01.005	South West Axonometric



c:\temp\VCOSD_B6_ARCH_DRAWING_00A.rvt

Check all dimensions and site conditions prior to commencement of any work, the purchase or ordering of any materials, fittings, plant, services or equipment and the preparation of shop drawings and or the fabrication of any components.

Do not scale drawings - refer to figured dimensions only. Any discrepancies shall immediately be referred to the architect for clarification.

All drawings may not be reproduced or distributed without prior permission from the architect.

Revision	Date	Description	Initial	Checked
2	16.04.18	ISSUE FOR SSDA	TG	FJM
1	22.02.18	ISSUE FOR SSDA	GH	GH

TFNSW
Victoria Cross OSD
Cover Page
Drawing List

Scale Not to scale @ A0
 Drawn Author Checked Checker
 Project no. S12041
 Status Project Status
 Plot Date 16/04/2018 2:55:17 PM
 Plot File
 Drawing no. A01.000
 Revision 2

Melbourne 1 Nicholson Street
Melbourne VIC 3000 Australia
T 03 8664 6200 F 03 8664 6300
email mel@batesmart.com.au
http://www.batesmart.com.au

Sydney 43 Brisbane Street
Surry Hills NSW 2010 Australia
T 02 8354 5100 F 02 8354 5199
email syd@batesmart.com.au
http://www.batesmart.com.au

Bates Smart Pty Ltd ABN 70 004 999 400

BATESSMART

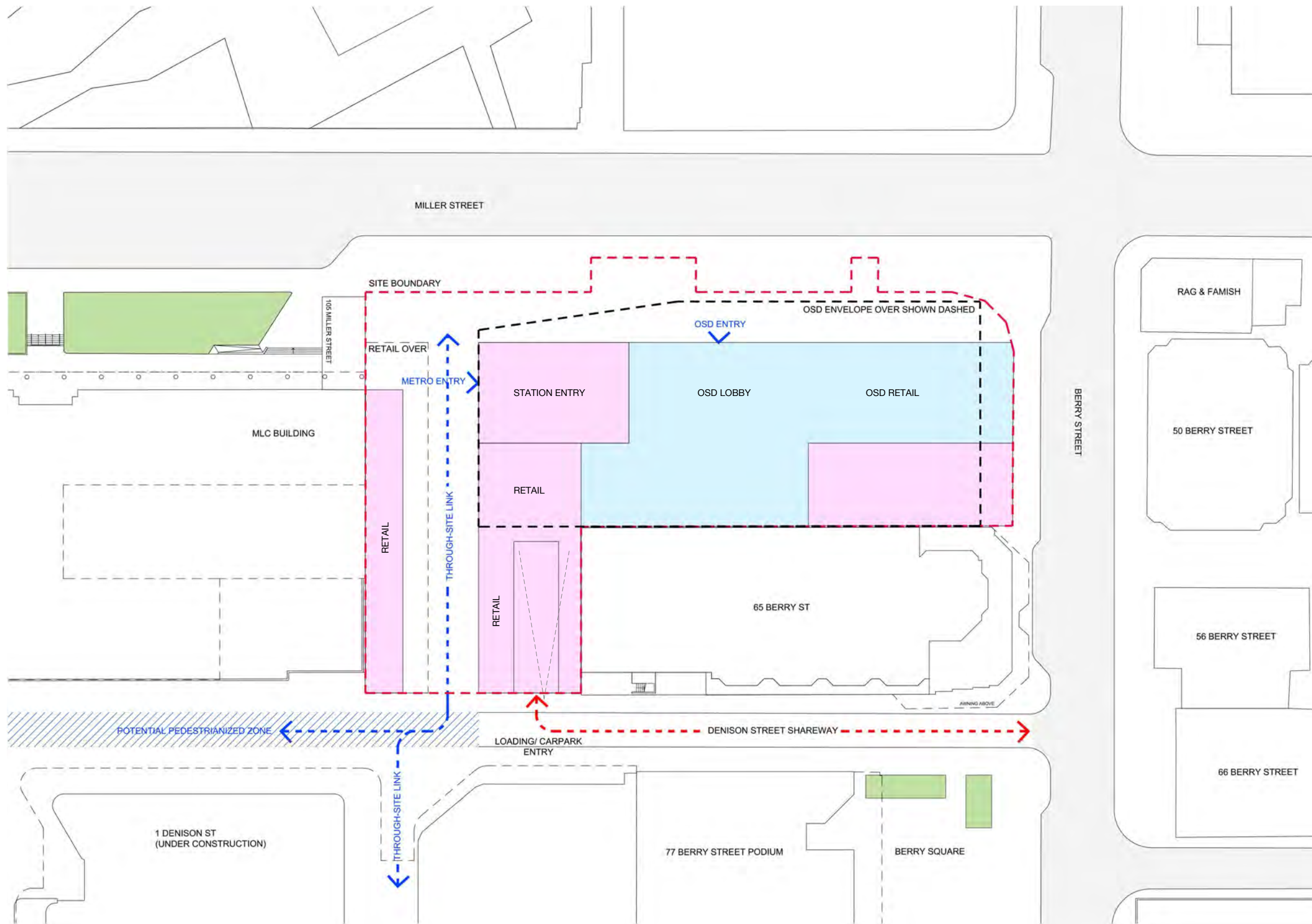

- KEY:**
- VICTORIA CROSS STATION CSST APPROVAL - INCLUDES STRUCTURE AND BUILDING INFRASTRUCTURE AND SPACE FOR LIFT CORES, ACCESS, PARKING, RETAIL AND BUILDING SERVICES FOR THE FUTURE OSD
 - OSD CONCEPT SSDA BUILDING ENVELOPE APPROXIMATE OSD LOBBY LOCATION INCLUDES RETAIL, CORE AND PLANT
 - PEDESTRIANISED ZONE
 - APPROXIMATE LOCATION OF TOWER ENVELOPE OVER
 - PEDESTRIAN MOVEMENT
 - VEHICULAR MOVEMENT

FOR INFORMATION

Check all dimensions and site conditions prior to commencement of any work, the purchase or ordering of any materials, fittings, plant, services or equipment and the preparation of shop drawings and or the fabrication of any components.

Do not scale drawings - refer to figured dimensions only. Any discrepancies shall immediately be referred to the architect for clarification.

All drawings may not be reproduced or distributed without prior permission from the architect.

Revision	Date	Description	Initial	Checked
2	16.04.18	ISSUE FOR SSDA	TG	FJM
1	22.02.18	ISSUE FOR SSDA	GH	GH

TFNSW
Victoria Cross OSD
Building Envelope
Indicative Ground Floor
Plan

Scale	Not to scale	@ A0
Drawn	Author	Checked
Project no.	S12041	
Status	Project Status	
Plot Date	16/04/2018 2:55:23 PM	
Plot File		
Drawing no.	Revision	
A01.001	2	

Melbourne 1 Nicholson Street
Melbourne VIC 3000 Australia
T 03 8664 6200 F 03 8664 6300
email mel@batesmart.com.au
http://www.batesmart.com.au

Sydney 43 Brisbane Street
Surry Hills NSW 2010 Australia
T 02 8354 5100 F 02 8354 5199
email syd@batesmart.com.au
http://www.batesmart.com.au

Bates Smart Pty Ltd ABN 70 004 999 400



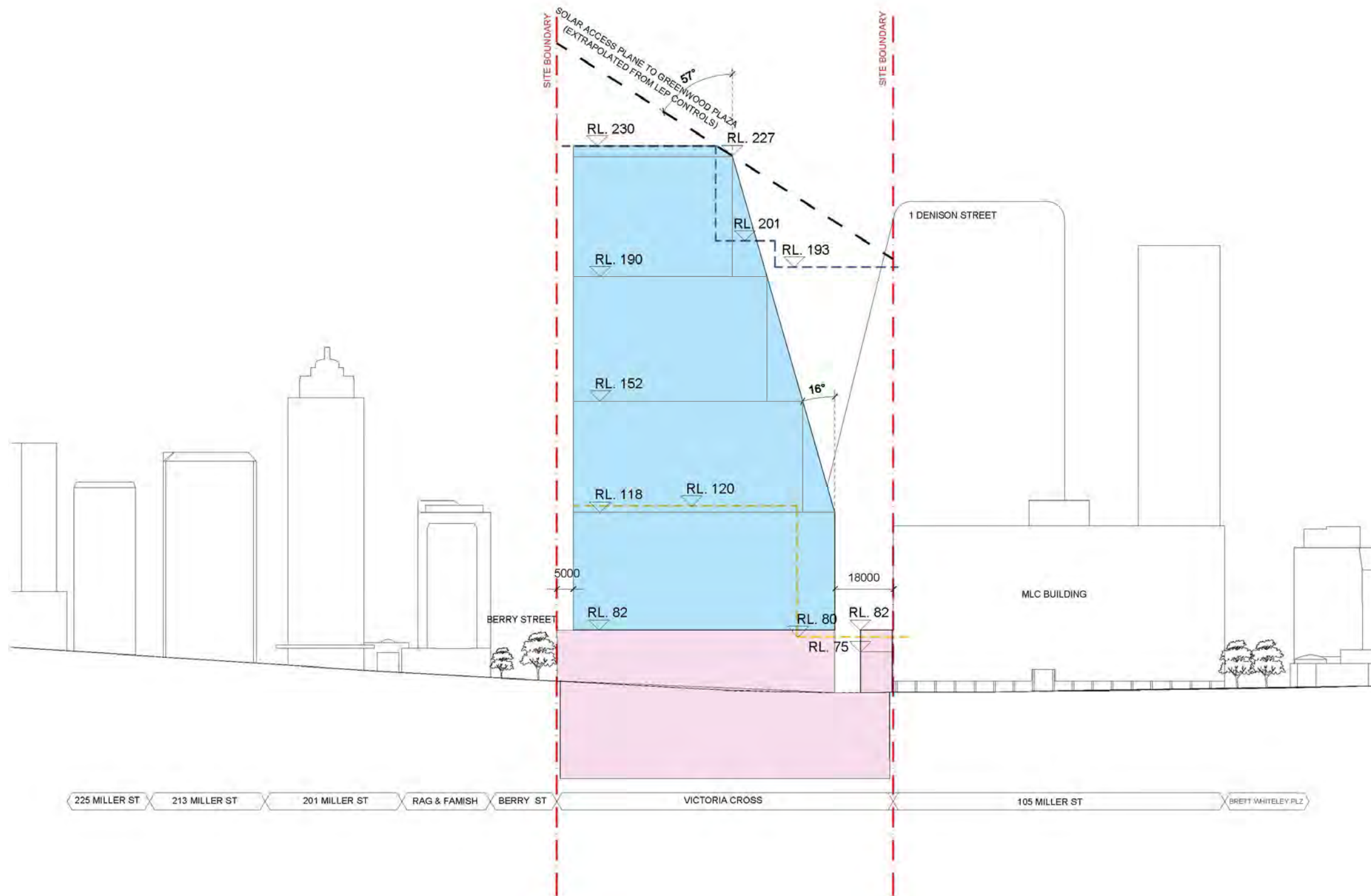

- KEY:
- MAXIMUM BUILDING HEIGHT NORTH SYDNEY CENTRE PLANNING PROPOSAL (AS AMENDED BY COUNCIL RESOLUTION 19TH MARCH 2018)
 - MAXIMUM BUILDING HEIGHT NORTH SYDNEY LEP 2013
 - VICTORIA CROSS STATION CSSI APPROVAL - INCLUDES STRUCTURE AND BUILDING INFRASTRUCTURE AND SPACE FOR LIFT CORES, ACCESS, PARKING, RETAIL AND BUILDING SERVICES FOR THE FUTURE OSD
 - OSD CONCEPT SSDA BUILDING ENVELOPE INCLUDES OSD AREAS INSIDE THE CSSI 'SHELL' BELOW GROUND AND IN THE PODIUM LEVELS

FOR INFORMATION

Check all dimensions and site conditions prior to commencement of any work, the purchase or ordering of any materials, fittings, plant, services or equipment and the preparation of shop drawings and or the fabrication of any components.

Do not scale drawings - refer to figured dimensions only. Any discrepancies shall immediately be referred to the architect for clarification.

All drawings may not be reproduced or distributed without prior permission from the architect.

Revision	Date	Description	Initial	Checked
2	16.04.18	ISSUE FOR SSDA	TG	FJM
1	22.02.18	ISSUE FOR SSDA	GH	GH

TFNSW
Victoria Cross OSD
Building Envelope
Miller Street Elevation

Scale	Not to scale	@ A0
Drawn	Author	Checked
Project no.	S12041	
Status	Project Status	
Plot Date	16/04/2018 2:55:27 PM	
Plot File		
Drawing no.	Revision	
A01.002	2	

Melbourne 1 Nicholson Street
Melbourne VIC 3000 Australia
T 03 8664 6200 F 03 8664 6300
email mel@batesmart.com.au
http://www.batesmart.com.au

Sydney 43 Brisbane Street
Surry Hills NSW 2010 Australia
T 02 8354 5100 F 02 8354 5199
email syd@batesmart.com.au
http://www.batesmart.com.au

Bates Smart Pty Ltd ABN 70 004 999 400



c:\temp\VCOSD_BE_ARCH_02017_02.dwg

KEY:

- MAXIMUM BUILDING HEIGHT NORTH SYDNEY CENTRE PLANNING PROPOSAL (AS AMENDED BY COUNCIL RESOLUTION 19TH MARCH 2018)
- - - MAXIMUM BUILDING HEIGHT NORTH SYDNEY LEP 2013
- VICTORIA CROSS STATION CSSI APPROVAL - INCLUDES STRUCTURE AND BUILDING INFRASTRUCTURE AND SPACE FOR LIFT CORES, ACCESS, PARKING, RETAIL AND BUILDING SERVICES FOR THE FUTURE OSD
- OSD CONCEPT SSDA BUILDING ENVELOPE INCLUDES OSD AREAS INSIDE THE CSSI 'SHELL' BELOW GROUND AND IN THE PODIUM LEVELS

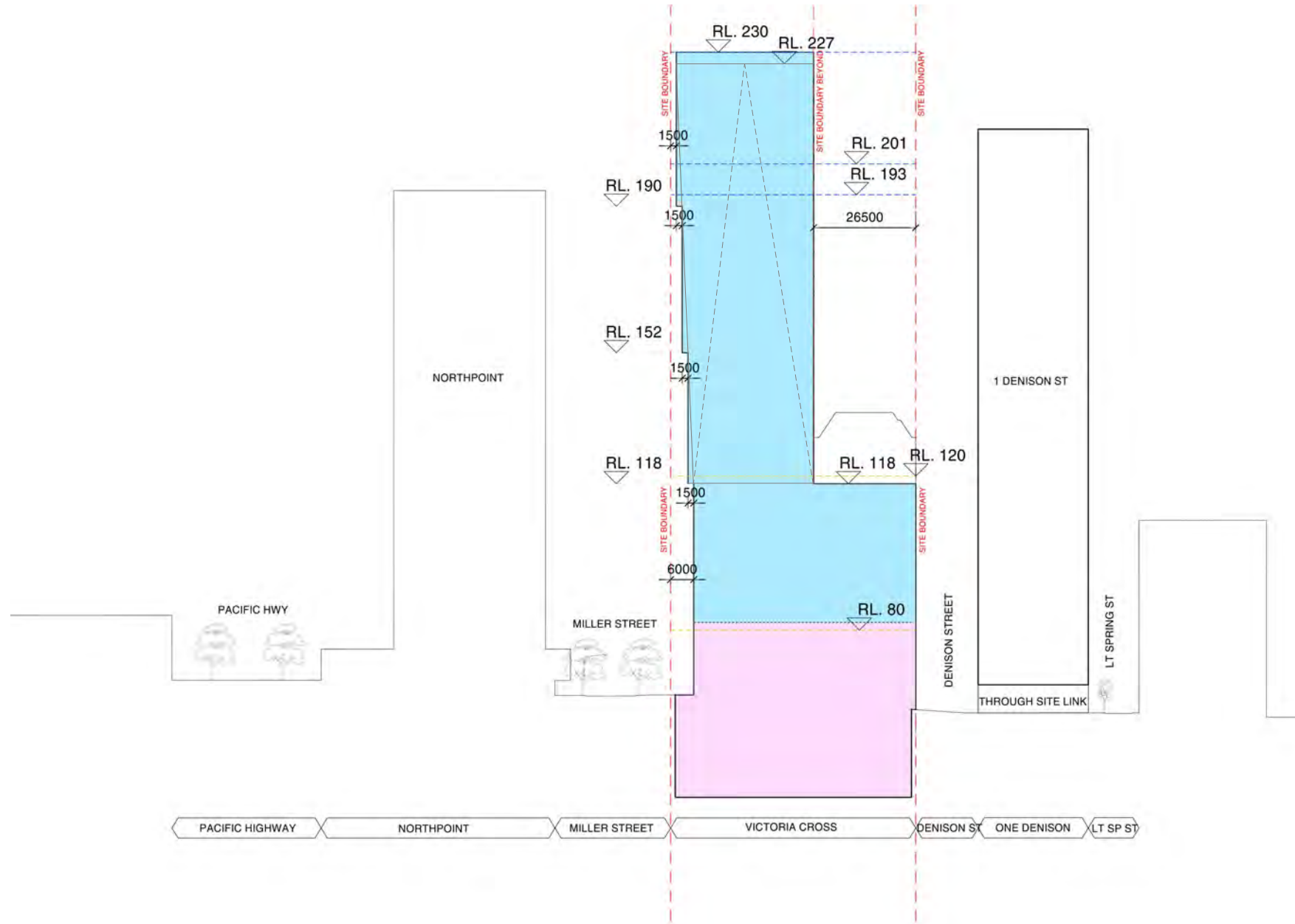

FOR INFORMATION

Check all dimensions and site conditions prior to commencement of any work, the purchase or ordering of any materials, fittings, plant, services or equipment and the preparation of shop drawings and or the fabrication of any components.

Do not scale drawings - refer to figured dimensions only. Any discrepancies shall immediately be referred to the architect for clarification.

All drawings may not be reproduced or distributed without prior permission from the architect.

Revision	Date	Description	Initial	Checked
2	16.04.18	ISSUE FOR SSDA	TG	FJM
1	22.02.18	ISSUE FOR SSDA	GH	GH

TFNSW
Victoria Cross OSD
Building Envelope
East West Section

Scale	Not to scale	@ A0
Drawn	Author	Checked
Project no.	S12041	
Status	Project Status	
Plot Date	16/04/2018 2:55:30 PM	
Plot File		
Drawing no.	Revision	
A01.003	2	

Melbourne 1 Nicholson Street
Melbourne VIC 3000 Australia
T 03 8664 6200 F 03 8664 6300
email mel@batesmart.com.au
http://www.batesmart.com.au

Sydney 43 Brisbane Street
Surry Hills NSW 2010 Australia
T 02 8354 5100 F 02 8354 5199
email syd@batesmart.com.au
http://www.batesmart.com.au

Bates Smart Pty Ltd ABN 70 004 999 400

BATESSMART

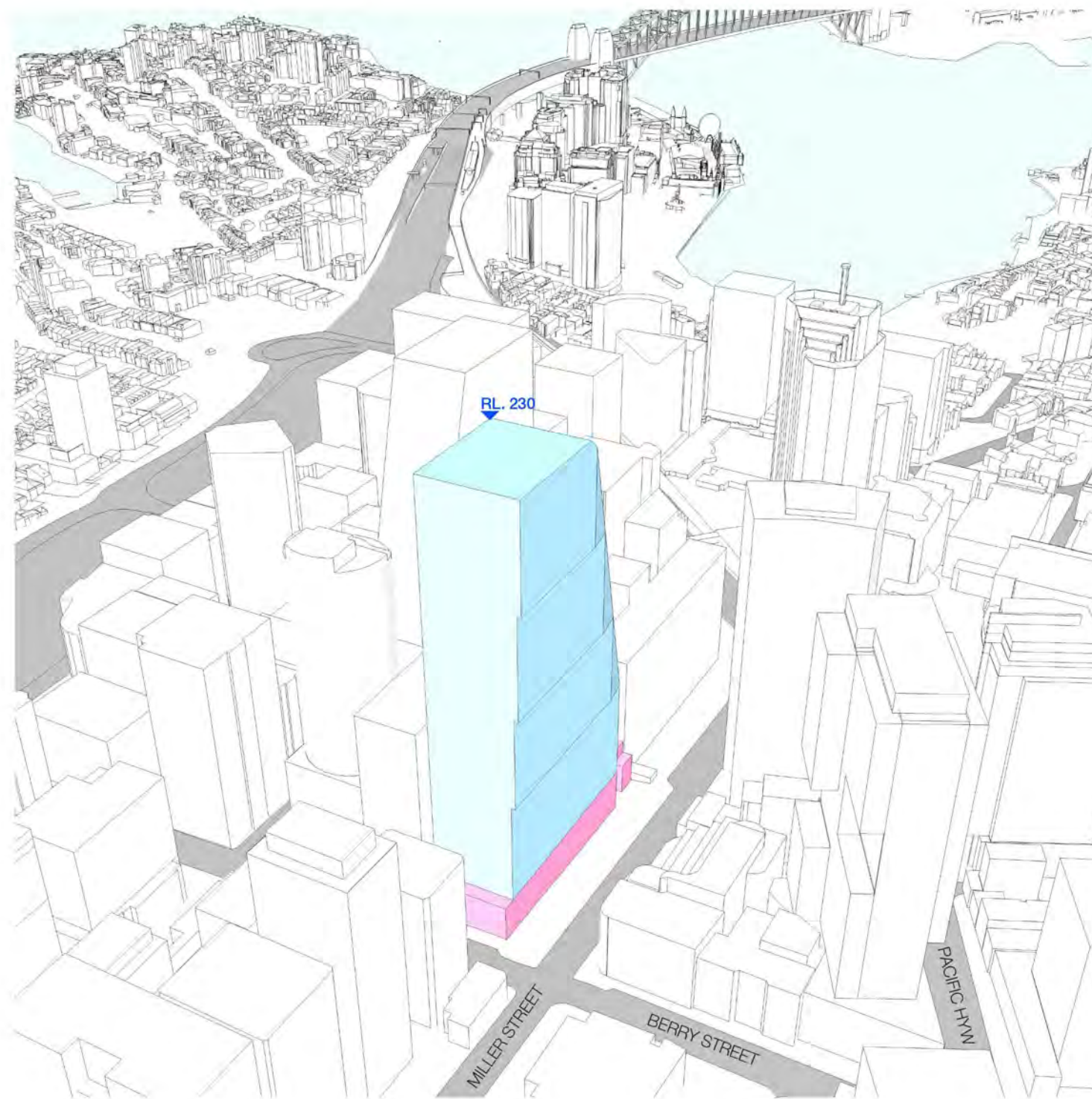

KEY:

- VICTORIA CROSS STATION CS&I APPROVAL - INCLUDES STRUCTURE AND BUILDING INFRASTRUCTURE AND SPACE FOR LIFT CORES, ACCESS, PARKING, RETAIL AND BUILDING SERVICES FOR THE FUTURE OSD

- OSD CONCEPT SSDA BUILDING ENVELOPE INCLUDES OSD AREAS INSIDE THE CS&I 'SHELL' BELOW GROUND AND IN THE PODIUM LEVELS

FOR INFORMATION

Check all dimensions and site conditions prior to commencement of any work, the purchase or ordering of any materials, fittings, plant, services or equipment and the preparation of shop drawings and or the fabrication of any components.

Do not scale drawings - refer to figured dimensions only. Any discrepancies shall immediately be referred to the architect for clarification.

All drawings may not be reproduced or distributed without prior permission from the architect.

c:\temp\VCOS&I_BE_ARCH_02017_00A.rvt

Revision	Date	Description	Initial	Checked
2	16.04.18	ISSUE FOR SSDA	TG	FJM
1	22.02.18	ISSUE FOR SSDA	GH	GH

TFNSW
Victoria Cross OSD
Building Envelope
North West Axonometric

Scale	Not to scale	@ A0
Drawn	Author	Checked
Project no.	S12041	
Status	Project Status	
Plot Date	16/04/2018 2:55:35 PM	
Plot File		
Drawing no.	Revision	
A01.004	2	

Melbourne 1 Nicholson Street
Melbourne VIC 3000 Australia
T 03 8664 6200 F 03 8664 6300
email mel@batesmart.com.au
http://www.batesmart.com.au

Sydney 43 Brisbane Street
Surry Hills NSW 2010 Australia
T 02 8354 5100 F 02 8354 5199
email syd@batesmart.com.au
http://www.batesmart.com.au

Bates Smart Pty Ltd ABN 70 004 999 400

BATESSMART

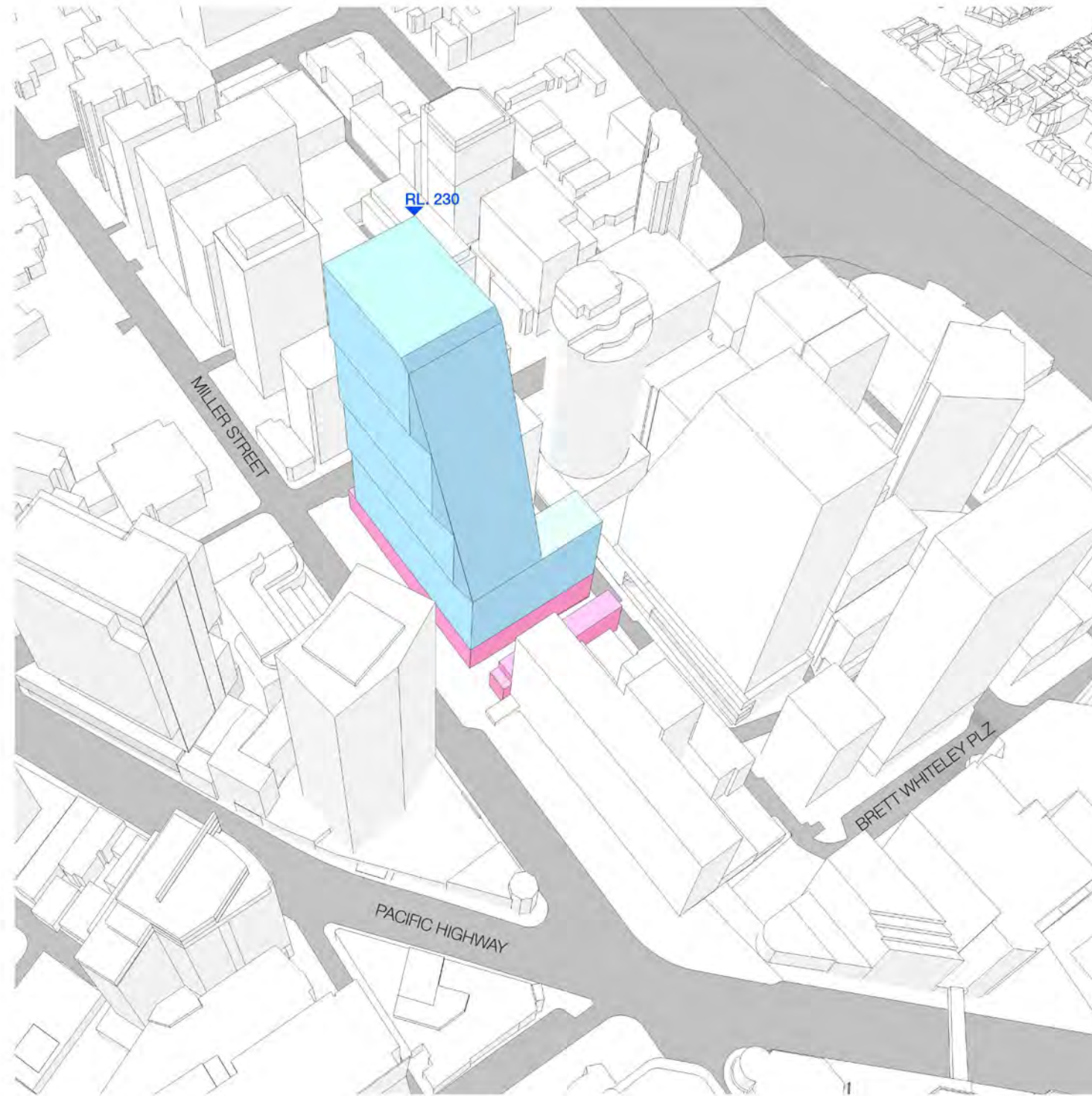

KEY:

- VICTORIA CROSS STATION
 CSSI APPROVAL - INCLUDES
 STRUCTURE AND BUILDING
 INFRASTRUCTURE AND
 SPACE FOR LIFT CORES,
 ACCESS, PARKING, RETAIL
 AND BUILDING SERVICES
 FOR THE FUTURE OSD
- OSD CONCEPT SSIDA
 BUILDING ENVELOPE
 INCLUDES OSD AREAS
 INSIDE THE CSSI 'SHELL'
 BELOW GROUND AND IN
 THE PODIUM LEVELS

FOR INFORMATION

Check all dimensions and site conditions prior to commencement of any work, the purchase or ordering of any materials, fittings, plant, services or equipment and the preparation of shop drawings and or the fabrication of any components.

Do not scale drawings - refer to figured dimensions only. Any discrepancies shall immediately be referred to the architect for clarification.

All drawings may not be reproduced or distributed without prior permission from the architect.

Revision	Date	Description	Initial	Checked
2	16.04.18	ISSUE FOR SSIDA	TG	FJM
1	22.02.18	ISSUE FOR SSIDA	GH	GH

TFNSW
Victoria Cross OSD

Building Envelope
South West
Axonometric

Scale	Not to scale	@ A0
Drawn	Author	Checked
Project no.	S12041	
Status	Project Status	
Plot Date	16/04/2018 2:55:41 PM	
Plot File		
Drawing no.	Revision	
A01.005	2	

Melbourne 1 Nicholson Street
Melbourne VIC 3000 Australia
T 03 8664 6200 F 03 8664 6300
email mel@batesmart.com.au
http://www.batesmart.com.au

Sydney 43 Brisbane Street
Surry Hills NSW 2010 Australia
T 02 8354 5100 F 02 8354 5199
email syd@batesmart.com.au
http://www.batesmart.com.au

Bates Smart Pty Ltd ABN 70 004 999 400

BATESSMART